

52 14 000 Removing and installing left or right front seat (normal / electric)**Note:**

[Removal with faulty gear](#) for longitudinal seat adjustment.

[Remove front head restraint.](#)

**Warning!**

Observe [safety regulations](#) for handling airbag modules and pyrotechnical seatbelt tensioners.

Incorrect or improper handling may trigger the pyrotechnical belt tensioner or side airbag and thereby cause injury.

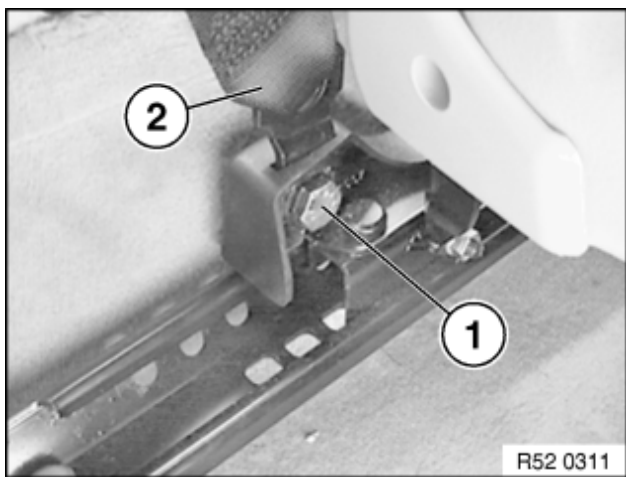

Move front seat forwards/upwards as far as possible.

Switch off ignition!

Release seatbelt screw (1) and feed out seatbelt strap (2).

Installation:

[Tightening torque: 72 11 11AZ.](#)

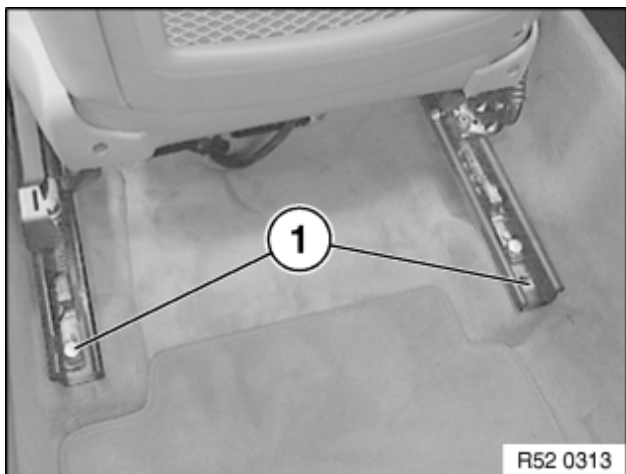

Move front seat forwards/upwards as far as possible.

Release screws (1).

[Tightening torque: 52 10 1AZ.](#)

Move front seat backwards/downwards as far as possible.

If necessary, unclip protective caps upwards.

Unfasten screws (3).

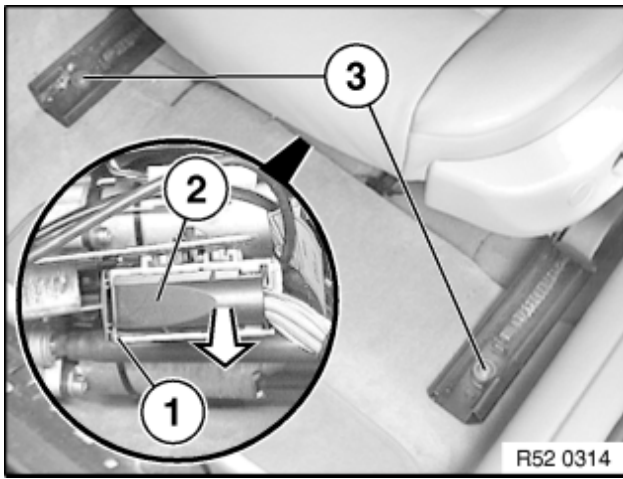

Move seat runners forward so that they are flush.
Unlock lock (1) and disconnect plug connection (2).

Caution!

Cover door sill with protective covers (risk of damage).

Lift out front seat.

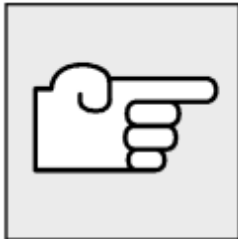
**Installation:**

Floor carpet must not enter area between seat rails and floor panel beside screw points (grating noises).

[Tightening torque, 52 10 1AZ.](#)